

PERMIT NUMBER: NYR11I563

INSPECTION REPORT #134

Baker Rd/Dunlap Ave/ South Street Rd, Marcellus

Location

2/14/24 10:30 am

Date and Time of Inspection

Caleb Zipp, EIT

Trained Inspector

Qualified Inspector Signature

James Trasher, PE

Qualified Inspector

Qualified Inspector Signature

*The above signed acknowledges that, to the best of his/her knowledge, all information provided on the following forms is accurate and complete.*

- Weekly Inspection
- 2x/Week Inspection (TMDL or +5 ac)
- Monthly Inspection

Current Phase of Construction (if applicable): N/A

Estimated Current Total Disturbed Area: 2.00 ac ± (site snow covered)

**IMMEDIATE ACTION ITEMS / INSPECTION SUMMARY:**

It is the responsibility of the Qualified Inspector to notify the owner/operator and appropriate contractor of any corrective actions that need to be taken within one (1) business day of the completion of an inspection. It is the responsibility of the contractor (subcontractor) to begin implementing the corrective actions within one (1) business day of this notification and complete the corrective action within a reasonable time frame. If there are action items from the previous inspection which have not been addressed, so note.

Per the GP-0-20-001, Digital photographs with date stamp, that clearly show the condition of all practices that have been identified as needing corrective actions shall be included with each inspection report. The qualified inspector shall attach paper color copies of the digital photographs to the inspection report being maintained onsite within seven (7) calendar days of the date of the inspection. The qualified inspector shall also take digital photographs, with date stamp, that clearly show the condition of the practice(s) after the corrective action has been completed. Paper color copies of these digital photographs shall be attached to the inspection report, documenting the completion of the corrective action work within seven (7) calendar days of that inspection.

**ACTION ITEMS:**

None

**INSPECTION SUMMARY:**

Home construction taking place at the time of inspection.

**1. GENERAL HOUSEKEEPING**

*Includes description of the weather and soil conditions (e.g. dry, wet, saturated) during the time of the inspection, a description of the condition of the runoff at all points of discharge from the construction site (including identification of any discharges of sediments from construction site), inspection for stream/pond turbidity, oil and floating substances, visible oil film, or globules or grease, contractor preparedness for implementation of erosion and sediment control, impact on adjacent property, and dust control.*

**Yes      No**

      Is there immediate action required regarding General Housekeeping?

**Notes:**

**Weather: Low 20's, Snowing**  
**Soils: Frozen**  
**Discharge Points: No evidence of off-site sediment transport**

**2. EXCAVATION DEWATERING**

*Includes inspection ensuring that clean water from upstream pool is being pumped to the downstream pool, that sediment laden water from work area is being discharged to a silt-trapping device, and that constructed upstream berm has one-foot minimum freeboard.*

**Yes      No**

      Is there immediate action required regarding Excavation Dewatering?

**Notes:**

**3. INTERCEPTOR DIKES AND SWALES**

*Includes inspection ensuring that dikes and swales are installed per plan with minimum side slopes 2H:1V or flatter, are stabilized by geotextile fabric, seed, or mulch with no erosion occurring, and that sediment-laden runoff is directed to sediment trapping structure.*

**Yes      No**

      Is there immediate action required regarding an Interceptor Dike or Swale?

**Notes:**

#### 4. EROSION & SEDIMENT CONTROL

*Includes inspection ensuring that erosion and sediment control practices are located and installed correctly, BMPs are maintained per specifications, stockpiles are stabilized and contained, de-watering operations prevent direct discharges to sensitive features, and that clearing and grading operations are divided into stages for large areas. Identification of all erosion and sediment control practices that need repair or maintenance.*

Yes      No

Is there immediate action required regarding Erosion & Sediment Control?

Notes:

#### 5. AREAS OF DISTURBANCE

*Includes description and sketch of areas that are disturbed at the time of the inspection and areas that have been stabilized (temporary and/or final) since last inspection.*

Yes      No

Is there immediate action required regarding stabilizing disturbed areas?

Notes:

#### 6. STABILIZED CONSTRUCTION ENTRANCE

*Includes inspection ensuring that stone is clean enough to effectively remove mud from vehicles, is installed per standards and specifications, that all traffic use the stabilized entrance to enter and leave site, and that adequate drainage is provided to prevent ponding at entrance.*

Yes      No

Is there immediate action required regarding a Stabilized Construction Entrance?

Notes:

### 7. REINFORCED SILT FENCE

*Includes inspection ensuring that silt fence is installed on contour, 10 feet from toe of slope, joints are constructed by wrapping the two ends together for continuous support, steel posts installed ( if applicable), installed on downstream side of slope, maximum 6' intervals with 6 x 6 inch 14 gage wire, fabric is buried minimum of 6 inches, posts are stable, fabric is tight and without rips or frayed areas, and that sediment accumulation is less than 1/3 the height of the silt fence.*

Yes      No

      Is there immediate action required regarding Silt Fence?

Notes:

### 8. STONE CHECK DAM

*Includes inspection ensuring that stone check dam channels are without erosion (i.e., flow is not eroding soil underneath or around the structure), that check dam is in good condition (i.e., rocks have not been displaced and no permanent pools behind the structure), and that sediment accumulation is less than design capacity.*

Yes      No

      Is there immediate action required regarding a Stone Check Dam?

Notes:

### 9. FILTER FABRIC (DROP) INLET PROTECTION

*Includes inspection ensuring that protection is installed with 2-inch x 4-inch wood frame and wood posts, with maximum 3-foot spacing, is buried a minimum of 8 inches and secured to frame/posts with staples at max 8-inch spacing, has posts with 3-foot maximum spacing between posts, has posts that are stable, fabric is tight and without rips or frayed areas, and that sediment accumulation is within design capacity.*

Yes      No

      Is there immediate action required regarding Filter Fabric (Drop) Inlet Protection?

Notes:



**10. SILTSACK® INLET PROTECTION**

*Includes inspection ensuring that protection is installed per manufacturers specifications and is maintained per manufacturers recommendations.*

**Yes**      **No**

      Is there immediate action required regarding the Inlet Protection?

**Notes:**

**11. TEMPORARY SEDIMENT TRAP**

*Includes inspection ensuring that outlet structure is constructed per the approved plan or drawing, that geotextile fabric has been placed beneath rock fill, and that sediment accumulation is within design capacity.*

**Yes**      **No**

      Is there immediate action required regarding Temporary Sediment Traps?

**Notes:**

**12. CONCRETE WASHOUT**

*Includes inspection ensuring that the concrete washout is constructed and maintained per the approved plan or drawing.*

**Yes**      **No**

      Is there immediate action required regarding Concrete Washouts?

**Notes:**

**13. STORMWATER BASIN**

*Includes inspection ensuring that Permanent Stormwater Basins are installed per plans and specifications.*

Yes      No

Is there immediate action required regarding Stormwater Basins?

Notes:

**14. CURRENT PHASE OF POST-CONSTRUCTION STORMWATER PRACTICES**

*Includes inspection of current phase of all post-construction stormwater management practices, identification of all construction that is not in conformance with the SWPPP and technical standards, identify corrective action(s) that must be taken to install, repair, replace or maintain erosion and sediment control practices, and to correct deficiencies identified with the construction of post-construction stormwater management practice(s).*

Yes      No

Is there immediate action required regarding the current phase of post-construction stormwater management practices?

Notes:

**ADDITIONAL NOTES / MODIFICATIONS**

**Detention pond will need to be dredged at the end of construction. Catch basins will need to be cleaned out as well at the end of construction.**



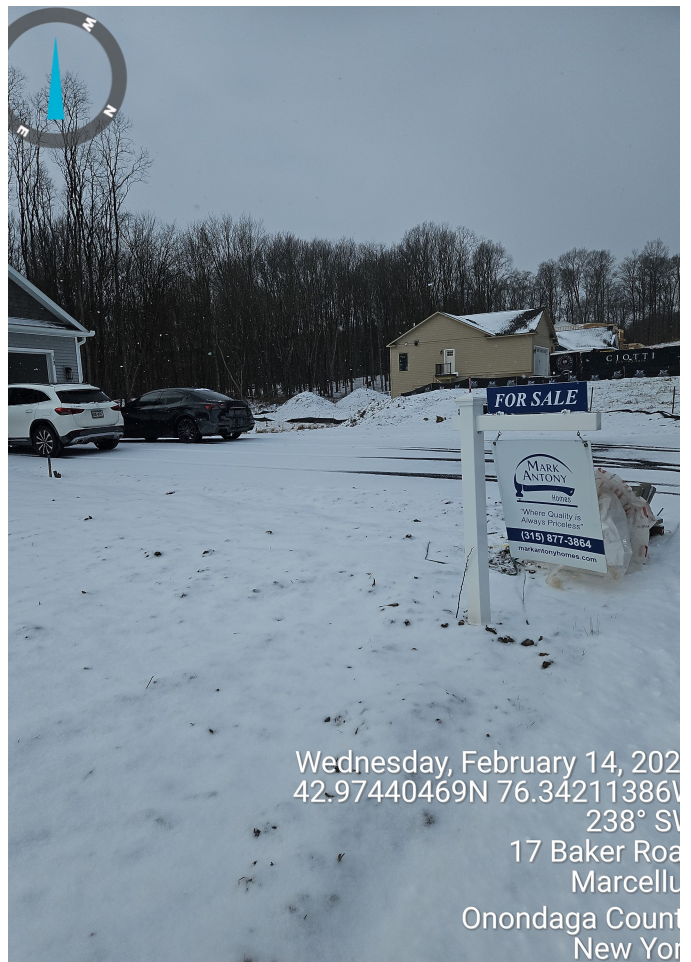





Wednesday, February 14, 202  
42.9743912N 76.34159192W  
154° S  
4185 South Street Road  
Marcellu  
Onondaga Count  
New Yor